

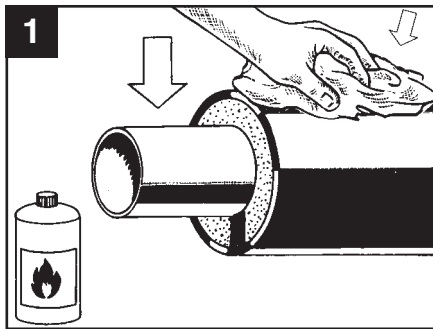

Material and equipment

- Appropriate size CCS-DHEC end cap
- Propane gas bottle, regulator and gauge, hose and torch BN40 (or equivalent)
- Abrasive tape (grain 60-80) + steel brush
- PE cleaner + dry cleaning rags
- Gloves and safety goggles
- Standard safety equipment as prescribed by local regulations
- In case of rain use a tent or umbrella
- District Heating temperature stick



Preparation

The casing pipe and the service pipe must be dry and free of foreign materials such as oils, greases, foam, etc. Use PE-cleaner.

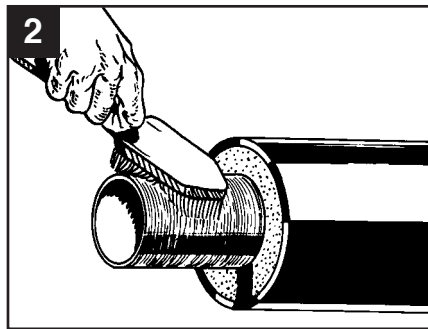

Remove all loose particles from casing pipe and service pipe. Deep scars in the casing pipe must be removed or scraped flat.

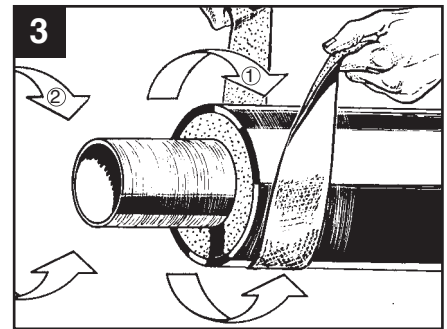

Firstly abrade the casing using a fresh abrasive tape. Then abrade the service pipe to remove the contamination.

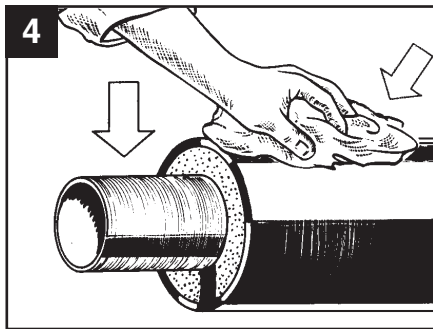

Remove all loose particles from abrading on casing pipe and service pipe with a dry and clean rag.

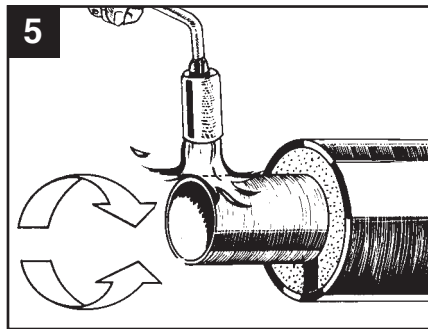

Pre-heating

Preheat the service pipe first to 60°C minimum. Avoid direct contact between flame and foam.

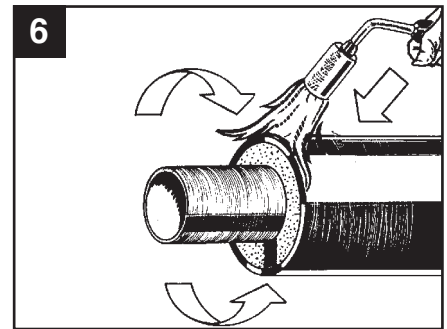

Preheat the casing pipe to 60°C minimum.

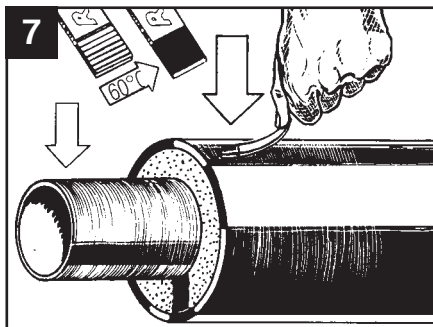

Check the temperature of casing pipe and service pipe with the temperature indicator. If you see an immediate color change, then the correct temperature has been reached.

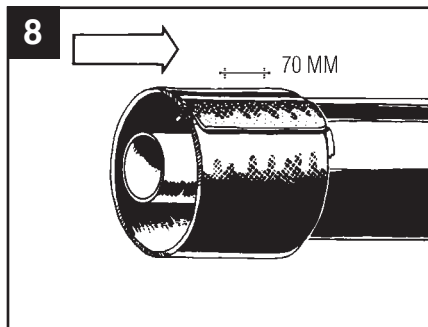

Positioning

Put a mark on the casing pipe 70 mm from the edge. Position the end cap over the pipe end up to the mark. Close the zipper.

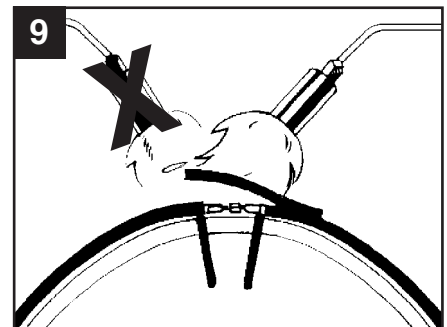

Installation

Start heating the top of the protective patch. Avoid direct flame contact with the zipper.

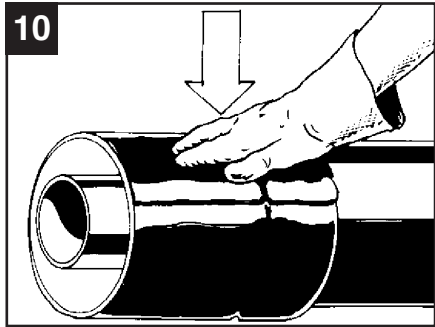

10 Push down the protective patch with a gloved hand.

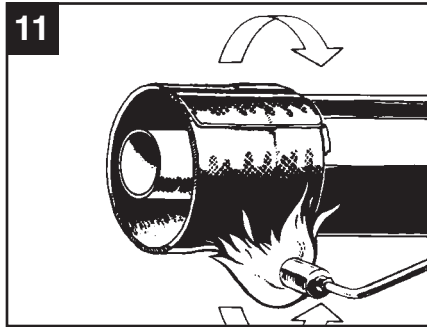

11 Start heating the end cap over the casing pipe first. Move the flame in a circular motion around the pipe, until the end cap has fully recovered onto the casing pipe. Allow it to cool a little before shrinking the end cap over the step-down and the service pipe.
 Note: If a second end cap has to be installed on the other pipe side of the welded joint, shrink it down first only on the casing pipe before proceeding with the next step.

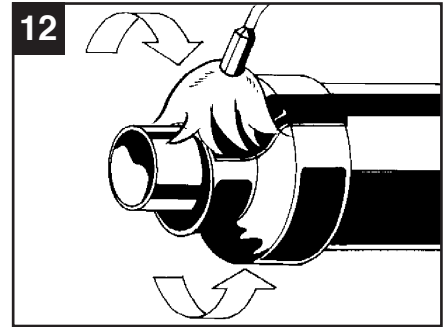

12 Shrink the end cap over the step-down and onto the service pipe, keeping the flame moving around the pipe. Stop heating when the end cap has fully recovered and the appearance of the part has become totally smooth.

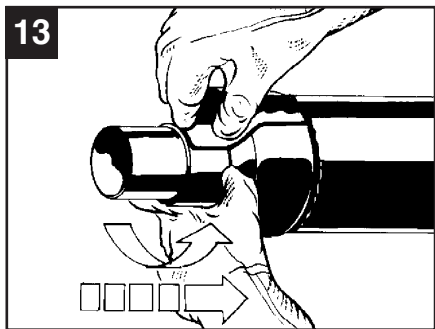

13 Push the closure area in place with gloved hand or blunt tool.

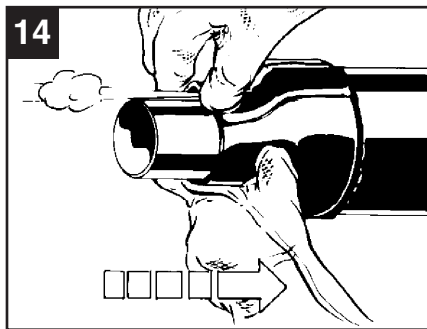

14 If necessary, squeeze the end cap together on the service pipe to relieve air entrapments. You can determine whether the adhesive has melted properly by carefully pushing the hot end cap a short distance along the service pipe. The small wrinkles which form, should pull themselves immediately flat again.

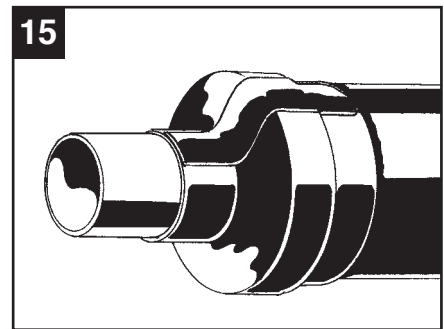

Inspection

The end cap should be fully recovered onto the casing pipe and service pipe without air entrapments. There should be no burn-holes or upstanding edges. When the product has cooled down completely, cut off the protruding parts of the zipper at both edges. Be careful not to damage the pipe while doing this.

Berry Plastics warrants that the product conforms to its chemical and physical description and is appropriate for the use stated on the technical data sheet when used in compliance with Berry Plastics written instructions. Since many installation factors are beyond the control of Berry Plastics, the user shall determine the suitability of the products for the intended use and assume all risks and liabilities in connection herewith. Berry Plastics liability is stated in the standard terms and conditions of sale. Berry Plastics makes no other warranty either expressed or implied. All information contained in this technical data sheet is to be used as a guide and is subject to change without notice. This technical data sheet supersedes all previous data sheets on this product.



CORROSION PROTECTION GROUP
www.berrycpg.com

Headquarters : Berry Plastics Tapes & Coatings Division, Franklin MA, USA

Franklin, MA, USA
 Tel: +1 508 918 1714
 US Toll Free: +1 800 248 0149
 Fax: +1 508 918 1910
 CPG@berrypastics.com

Houston, TX, USA
 Tel: +1 713 676 0085
 US Toll Free: 01 888 676 7202
 Fax: +1 713 676 0086
 CPGH@berrypastics.com

Tijuana, Mexico
 Tel USA 858 633 9797
 Fax US: +858 633 9740
 Tel Mexico: +52 664 647 4397
 Fax Mexico: +52 664 647 4370
 CPGTJ@berrypastics.com

Aarschot, Belgium
 Tel: +32 16 55 36 00
 Fax: +32 16 55 36 74
 CPG@berrypastics.com

Baroda, India
 Tel: +91 2667 264721
 Fax: +91 2667 264724
 CPGIN@berrypastics.com

Local Distributor / Representative:

For contact details of local Distributors / Representatives
 Please visit www.berrycpg.com.